

ACE

ACCESS PANELS

STANDARD RANGE TO SUIT DRYLINING CEILING SYSTEMS

BEADED DOOR/BEADED FRAME (BD/BF)

FIRE RATED & CONSTRUCTED IN ACCORDANCE WITH B.S 476 PART 20 1987

In modern buildings the provision for access into the ceiling void or wall cavity for inspection and maintenance to services are required. Ace have developed a comprehensive range of proprietary access panels that can be installed into any method of building construction, giving repeated ease of access.

Dependent on the situation ACE's range of access panels will accommodate your particular situation.

The Beaded Door, Beaded Frame Fire Rated access panel is constructed of a beaded metal door into a beaded frame. This access panel comes as a composite panel complete with one layer of 12.5mm fireline plasterboard. The door and frame have a perforated flange with a beaded stop detail to enable them to be tape and jointed/plastered into the ceiling. Once installed the door and frame can be decorated to match the surrounding ceiling.

Doors are fully demountable by use of the spring loaded hinge pin mechanism for quick and easy removal.

CONSTRUCTION

Manufactured from 1.2mm and 1mm electro-galvanised, zinc coated mild steel. All access panels are jig fabricated to ensure accuracy in tolerance during production

FINISHES

All ACE access panels are electrostatic powder coated white to RAL 9010, 20% gloss. Alternative colours are available from the RAL colour range.

INSTALLATION

Ace access panels should be screw fixed through the pre-punched holes in the side of the frame directly into the propriety grid. Independent support may be necessary dependent on site conditions. An allowance of +10mm greater than the panel size should be allowed in the structural opening.

FIRE RESISTANCE TEST

A fire resistance test was performed on a 600mm x 600mm panel fitted into a double layer 2 hr fire rated plasterboard ceiling assembly.

The test was conducted to the conditions of BS 476 Part 20 1987

The requirements of the above standard where maintained for 180 minutes giving effective protection for this period.



Test Reference BTC5535F Dated 11th November, The Building Test Centre

STANDARD SIZES with lock option

Panel Size	No of Doors	FD/BF/BL
300 x 300	1	Yes
600 x 300	1	Yes
450 x 450	1	Yes
600 x 600	1	Yes

Other Sizes are available please contact ACE with your exact requirements
Most of the above products are in stock or readily available.

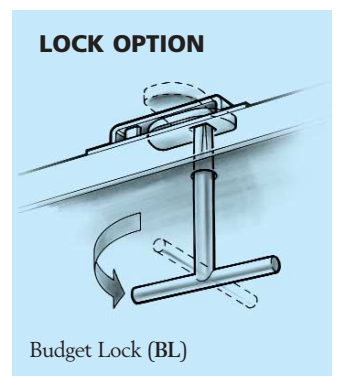

ACE CEILING PRODUCTS LTD.

Arley Industrial Estate, Springhill, Arley, Coventry CV7 8HN, U.K.
Telephone: +44 (0) 1676 541333 Fax: +44 (0) 1676 541241

E-mail : enquiries@ace-ceilings.co.uk
www : ace-ceilings.co.uk

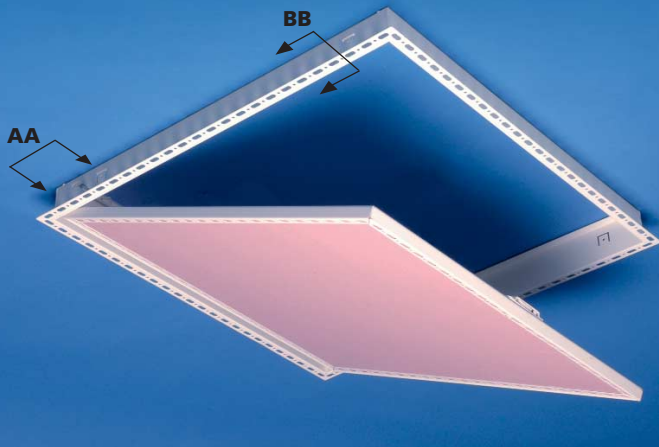

FIG 1 SECTION AA BEADED DOOR WITH BEADED FRAME FIRE RATED

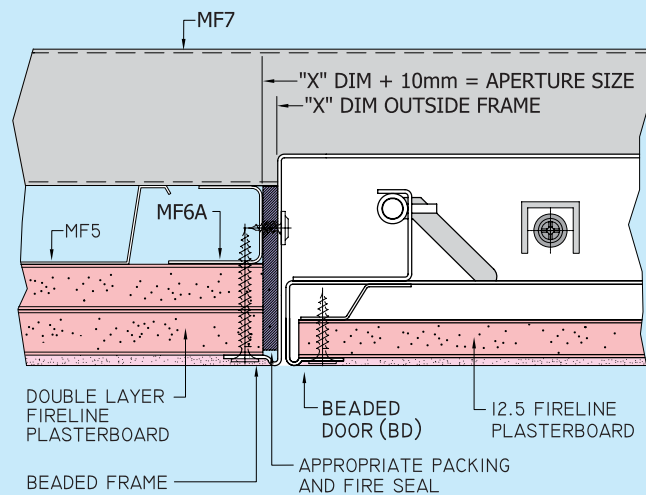

FIG 2 SECTION BB BEADED DOOR WITH BEADED FRAME FIRE RATED

